

Soils Map

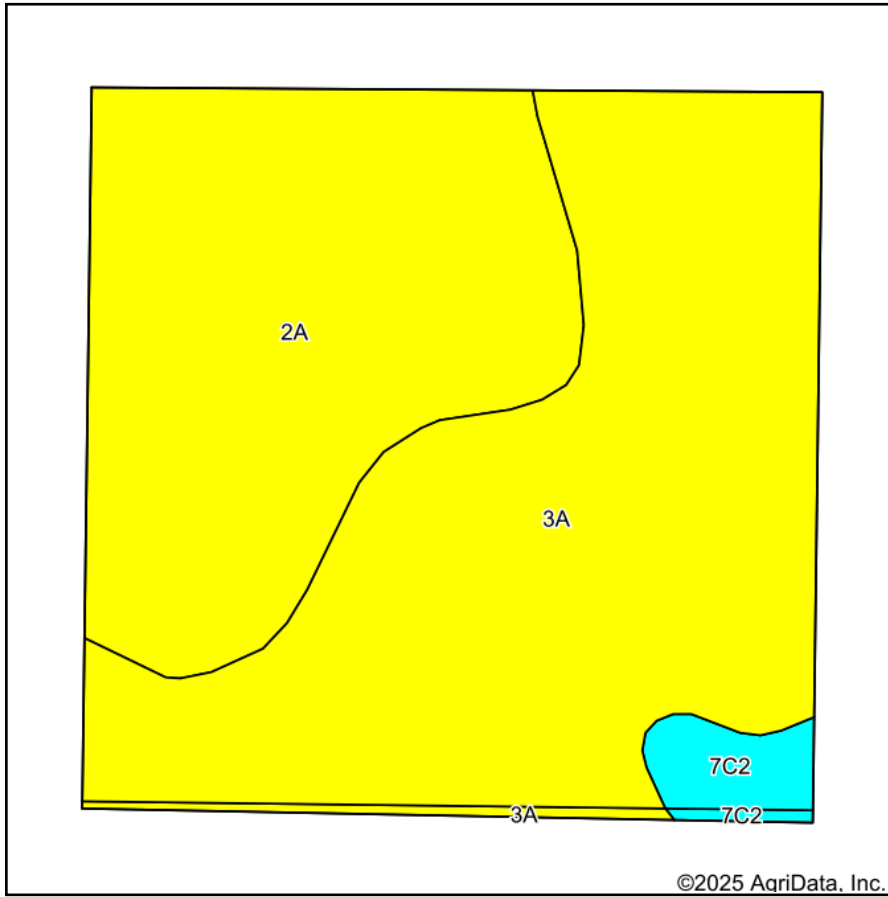

Soils data provided by USDA and NRCS.

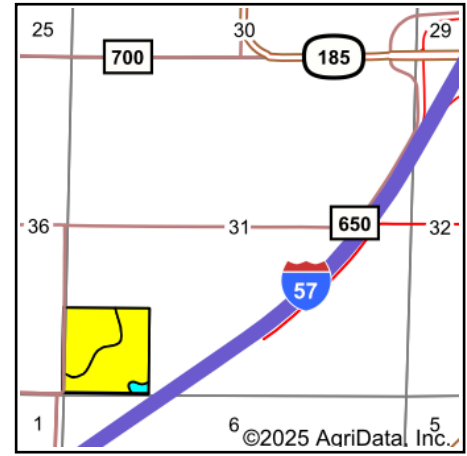

State: **Illinois**
 County: **Fayette**
 Location: **31-5N-4E**
 Township: **La Clede**
 Acres: **42.28**
 Date: **11/1/2025**

SCHMID
AUCTION
(217) 857-1507 • (618) 308-1551
 www.BidSchmid.com

Maps Provided By:
surety
CUSTOMIZED ONLINE MAPPING
 © AgriData, Inc. 2023 www.AgriDataInc.com



Area Symbol: IL051, Soil Area Version: 21
 Area Symbol: IL121, Soil Area Version: 22

Code	Soil Description	Acres	Percent of field	Il. State Productivity Index Legend	Restrictive Layer	Soil Drainage	*Subsoil rooting ^a	*Corn Bu/A	*Soybeans Bu/A	*Wheat Bu/A	*Oats Bu/A ^b	*Grass-legume hay, T/A	*Crop productivity index for optimum management	*n NCCPI Overall
3A	Hoyleton silt loam, 0 to 2 percent slopes	23.37	55.3%		0.9ft. (Abrupt textural change)	Somewhat poorly drained	FAV	146	46	58	0	5.00	108	78
2A	Cisne silt loam, 0 to 2 percent slopes	17.23	40.8%		1.4ft. (Abrupt textural change)	Poorly drained	FAV	149	46	59	0	5.00	109	79
**7C2	Atlas silt loam, 5 to 10 percent slopes, eroded	1.10	2.6%		> 6.5ft.	Somewhat poorly drained	UNF	**104	**36	**41	**48	**3.00	**80	71
3A	Hoyleton silt loam, 0 to 2 percent slopes	0.44	1.0%		0.9ft. (Abrupt textural change)	Somewhat poorly drained	FAV	146	46	58	0	5.00	108	78
**7C2	Atlas silt loam, 5 to 10 percent slopes, eroded	0.14	0.3%		> 6.5ft.	Somewhat poorly drained	UNF	**104	**36	**41	**48	**3.00	**80	71
Weighted Average								146	45.7	57.9	1.4	4.9	107.6	*n 78.2

Soils data provided by USDA and NRCS. Soils data provided by University of Illinois at Champaign-Urbana.

Table: Optimum Crop Productivity Ratings for Illinois Soil EFOTG are sourced from Bulletin 811 calculated Map Unit Base Yield Indices, and adjusted (Adj) for slope, erosion, and surface texture. Publication Date: 02-08-2023

Crop yields and productivity (B811 EFOTG) are maintained at the following USDA web site: 2023 Illinois Soil Productivity and Yield Indices:
<https://efotg.sc.egov.usda.gov/#!/state/IL/documents/section=2&folder=52809>

* The flood/pond factor has been removed for B811 indexes and yields.

** Base indexes from Bulletin 811 adjusted for slope, erosion, and surface texture according to the IL Soils EFOTG

b Soils in the southern region were not rated for oats and are shown with a zero "0".

e Soils in the well drained group were not rated for grass-legume and are shown with a zero "0".

*n: The aggregation method is "Weighted Average using all components"